

"140-4" Stainless Steel Enclosed Work Tables

w/ Stainless Steel Base, Panels and Undershelf
w/ Sliding Doors

w/ 6" Riser



**PREMIUM
SERIES**

14 GAUGE TOP			
24"WIDE	Qty	30"WIDE	Qty
140-31		140-36	
140-32		140-37	
140-33		140-38	
140-33A		140-38A	
140-34		140-39	
140-34A		140-39A	
140-35		140-40	

FEATURES:

- * 14 Gauge Stainless Steel Top
Type 300 stainless steel with # 3 polish, satin finish
- * Top is **Sound Deadened**
- * Reinforced with 1"x2" channel running entire length of table
- * 1 1/2" **Stallion Edge** on front and rear with side edges 90 degree bend down for table line-up
- * Stainless Steel Top, Cabinet and Undershelf
Type 300 stainless steel with # 3 polish, satin finish
- * Undershelf is secured in a fixed position, 14 7/8" above floor
- * Adjustable bullet feet
- * Shipped Standard Welded Set-Up
- * Optional drawers, casters, pot racks, etc. available
- * All models are approved by the National Sanitation Foundation and the U.S. Department of Agriculture.

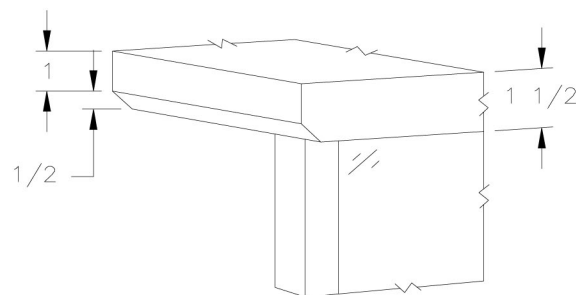

STALLION
SAFETY
EDGE

CONSTRUCTION:

Top: Stainless Steel Tops are TIG welded, Exposed welds are polished to match adjacent surface.

MATERIAL:

Top: 14 gauge stainless steel
Type 300 stainless steel with # 3 polish, satin finish

Doors: 16 gauge stainless steel
Type 300 stainless steel with # 3 polish, satin finish

Shelf: 18 gauge type 300 stainless steel # 3 polish, satin finish
** 6 ft. table only, 16 gauge type 300 stainless steel # 3 polish, satin finish

Legs: 1 1/2" Square O.D., 16 gauge type 300 tubular stainless steel # 3 polish, satin finish

Panels: 22 gauge stainless steel
Type 300 stainless steel with # 3 polish, satin finish

Feet: 1" adjustable stainless steel feet

OPTIONAL ACCESSORIES

	MODEL #	Qty
ELECTRICAL OUTLET CUTOUT		
CASTERS		
OVERSHELVES		
POT RACK		
SINKS		
INTERMEDIATE SHELF		
S/S BUN PAN RACK		



R.W. Rogers Company

610 S. Kirk Rd., St. Charles, IL 60174
Phone: 630-377-9033 * Fax: 630-377-2073
<http://www.rwrogerscompany.com>



DETAILED SPECIFICATIONS

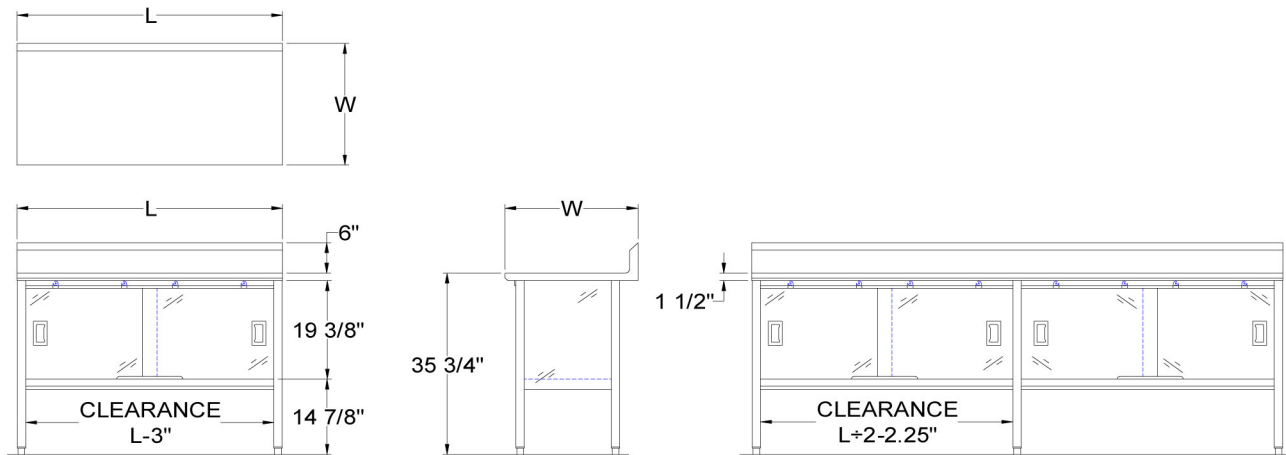

Shipped Welded Set-Up

Units 7 ft. and larger are furnished with six legs.

All dimensions are typical.

Tolerance +/- .500".

Finished size of undershelf.

Shelf length = length minus 4.875"

Shelf width = width minus 4.25"

14 GAUGE TOP

L	24" WIDE	WT.	30" WIDE	WT.
48	140-31	196	140-36	213
60	140-32	228	140-37	247
72	140-33	260	140-38	283
84	140-33A	299	140-38A	324
96	140-34	337	140-39	364
108	140-34A	370	140-39A	400
120	140-35	403	140-40	435



R.W. Rogers Company
 610 S. Kirk Rd., St. Charles, IL 60174
 Phone: 630-377-9033 * Fax: 630-377-2073
<http://www.rwrogerscompany.com>

