

"160-3" Stainless Steel Enclosed Work Tables

w/ Stainless Steel Base, Panels and Undershef
w/ Open Front

w/ 6" Riser



16 GAUGE TOP			
24"WIDE	Qty	30"WIDE	Qty
160-21		160-26	
160-22		160-27	
160-23		160-28	
160-23A		160-28A	
160-24		160-29	
160-24A		160-29A	
160-25		160-30	

FEATURES:

- * 16 Gauge Stainless Steel Top
Type 300 stainless steel with # 3 polish, satin finish
- * Top is **Sound Deadened**
- * Reinforced with 1"x2" channel running entire length of table
- * 1 1/2" **Stallion Edge** on front and rear with side edges 90 degree bend down for table line-up
- * Stainless Steel Top, Cabinet and Undershef
Type 300 stainless steel with # 3 polish, satin finish
- * Undershef is secured in a fixed position, 14 7/8" above floor
- * Adjustable bullet feet
- * Shipped Standard Welded Set-Up
- * Optional drawers, casters, pot racks, etc. available
- * All models are approved by the National Sanitation Foundation and the U.S. Department of Agriculture.

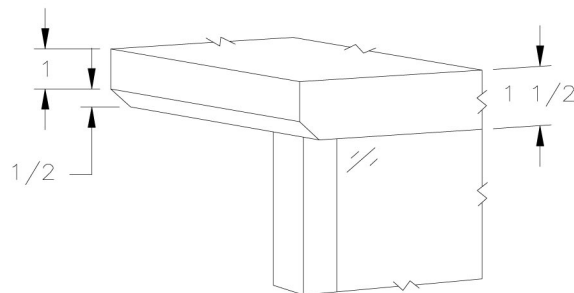

STALLION
SAFETY
EDGE

CONSTRUCTION:

Top: Stainless Steel Tops are TIG welded, Exposed welds are polished to match adjacent surface.

MATERIAL:

- Top: 16 gauge stainless steel
Type 300 stainless steel with # 3 polish, satin finish
- Shelf: 18 gauge type 300 stainless steel # 3 polish, satin finish
** 6 ft. table only, 16 gauge type 300 stainless steel # 3 polish, satin finish
- Legs: 1 1/2" Square O.D., 16 gauge type 300 tubular stainless steel # 3 polish, satin finish
- Panels: 22 gauge stainless steel
Type 300 stainless steel with # 3 polish, satin finish
- Feet: 1" adjustable stainless steel feet

OPTIONAL ACCESSORIES

	MODEL #	Qty
ELECTRICAL OUTLET CUTOUT		
CASTERS		
OVERSHELVES		
POT RACK		
SINKS		
INTERMEDIATE SHELF		
S/S BUN PAN RACK		



R.W. Rogers Company
610 S. Kirk Rd., St. Charles, IL 60174
Phone: 630-377-9033 * Fax: 630-377-2073
<http://www.rwrogerscompany.com>



DETAILED SPECIFICATIONS

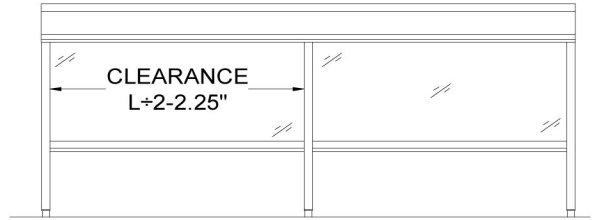
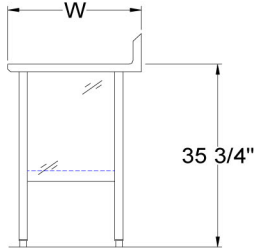
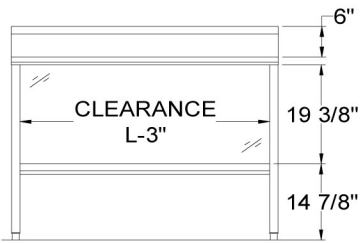
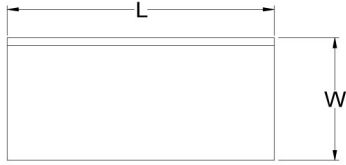

Shipped Welded Set-Up

Units 7 ft. and larger are furnished with six legs.

All dimensions are typical.

Tolerance +/- .500".

Finished size of undershelf.

Shelf length = length minus 4.875"

Shelf width = width minus 4.25"

16 GAUGE TOP

L	24" WIDE	WT.	30" WIDE	WT.
48	160-21	100	160-26	116
60	160-22	116	160-27	132
72	160-23	149	160-28	159
84	160-23A	250	160-28A	271
96	160-24	171	160-29	200
108	160-24A	307	160-29A	330
120	160-25	205	160-30	239



R.W. Rogers Company
 610 S. Kirk Rd., St. Charles, IL 60174
 Phone: 630-377-9033 * Fax: 630-377-2073
<http://www.rwrogerscompany.com>

