

"ESSR" Stainless Steel Top Tables with RISERS

w/ 16 Gauge Stainless Steel Work Top
w/ Galvanized Base and Undershelf



16 GAUGE TOP w/ UNDERSHELF					
24"WIDE	Qty	30"WIDE	Qty	36"WIDE	Qty
ESS086		ESS092		-	
ESS087		ESS093		ESS098	
ESS088		ESS094		ESS099	
ESS089		ESS095		ESS100	
ESS089A		ESS095A		ESS100A	
ESS090		ESS096		ESS101	
ESS090A		ESS096A		ESS101A	
ESS091		ESS097		ESS102	

FEATURES:

- * 16 Gauge Stainless Steel Top with 6" Riser
Type 300 stainless steel with # 3 polish, satin finish
- * Top is **Sound Deadened**
- * Reinforced with 1"x2" channel running entire length of table
- * 1 1/2" **Stallion Edge** on front and rear with side edges 90 degree bend down for table line-up
- * Galvanized Base and Undershelf
- * Undershelf is secured in a fixed position, 12" above floor
- * Adjustable bullet feet
- * Shipped knocked-down, easy - to - assemble
- * Optional drawers, casters, pot racks, etc. available
- * All models are approved by the National Sanitation Foundation and the U.S. Department of Agriculture.

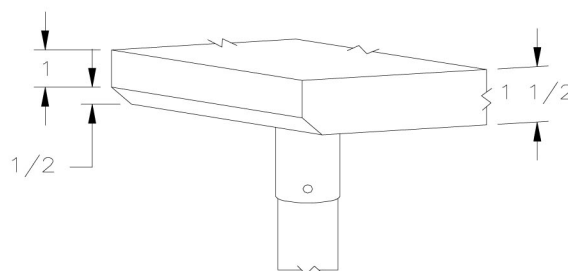

STALLION
SAFETY
EDGE

CONSTRUCTION:

Top: Stainless Steel Tops are TIG welded, Exposed welds are polished to match adjacent surface.

MATERIAL:

Top: 16 gauge stainless Steel
Type 300 stainless steel with # 3 polish, satin finish

Shelf: 18 gauge Galvanized Steel
** 6 ft. table only, 16 gauge galvanized steel

Legs: 1 5/8" Round O.D., 16 gauge tubular galvanized steel

Gussets: Galvanized Steel

Feet: 1" adjustable galvanized bullet feet

OPTIONAL ACCESSORIES

	MODEL #	Qty
DRAWER		
DRAWER LOCK		
ADJUSTABLE SHELF		
CASTERS		
OVERSHELVES		
SINKS		
POTRACK		
WELDED SET-UP		



R.W. Rogers Company

610 S. Kirk Rd., St. Charles, IL 60174
Phone: 630-377-9033 * Fax: 630-377-2073
<http://www.rwrogerscompany.com>



DETAILED SPECIFICATIONS

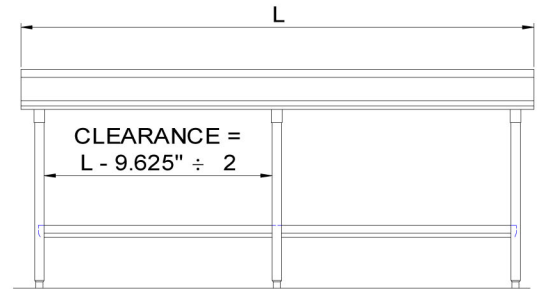
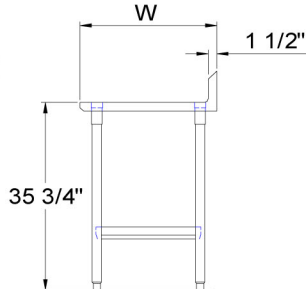
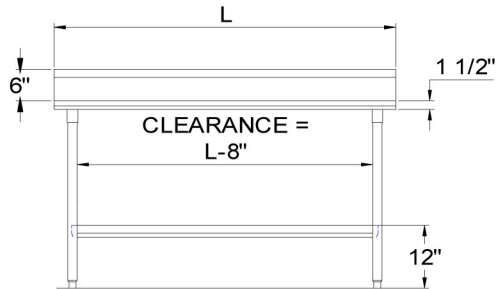
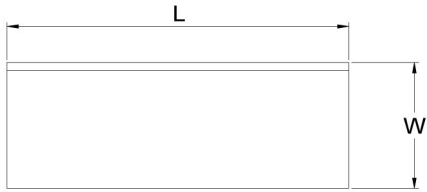

All units ship unassembled for reduced shipping cost.

Units 7 ft. and larger are furnished with six legs.

All dimensions are typical.

Tolerance +/- .500".

Finished size of undershelf.

Shelf length = length minus 4.875"

Shelf width = width minus 4.25"

16 GAUGE TOP & UNDERSHELF

L	24" WIDE	WT.	30" WIDE	WT.	36" WIDE	WT.
36	ESS086	56	ESS092	62	-	-
48	ESS087	67	ESS093	79	ESS098	87
60	ESS088	82	ESS094	94	ESS099	104
72	ESS089	95	ESS095	121	ESS100	122
84	ESS089	112	ESS095A	135	ESS100A	144
96	ESS090	129	ESS096	149	ESS101	165
108	ESS090A	142	ESS096A	168	ESS101A	183
120	ESS091	155	ESS097	180	ESS102	200



R.W. Rogers Company

610 S. Kirk Rd., St. Charles, IL 60174
Phone: 630-377-9033 * Fax: 630-377-2073
<http://www.rwrogerscompany.com>

